

**Residential Lettings
Property Management Specialists**

PO Box 301, Upminster, RM14 9DQ
01277 523358
enquiries@waderesidential.com
www.waderesidential.com

NEW TOWER BUILDINGS, WAPPING, LONDON, E1W 2PD



£1,900.00 PCM

SITUATED IN A PERIOD BUILDING ON WAPPING HIGH STREET IS THIS TWO BEDROOM THIRD FLOOR FLAT. SITUATED IN A SOUGHT AFTER LOCATION CLOSE TO THE THAMES AND NOT FAR FROM WAPPING STATION. IDEALLY SUIT A PROFESSIONAL COUPLE. EPC RATING C. COUNCIL TAX BAND D. DAMAGES DEPOSIT £1,900.00

- TWO BEDROOMS
- OPEN PLAN LOUNGE AND KITCHEN
- BATHROOM/WC
- REDECORATED THROUGHOUT
- GAS CENTRAL HEATING
- CONVENIENT LOCATION
- PERIOD BUILDING
- UNFURNISHED





Approx Gross Internal Area
44 sq m / 477 sq ft

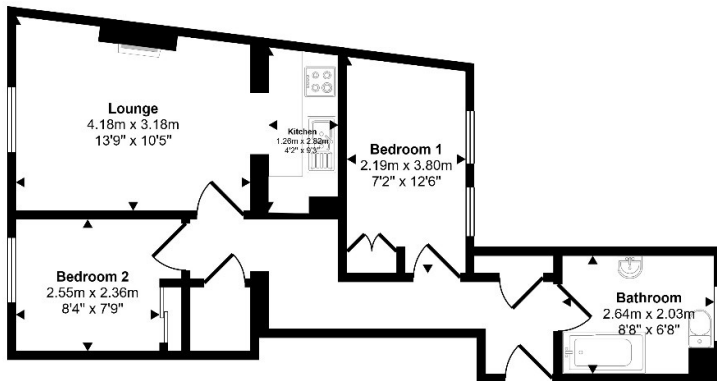

Floorplan

This floorplan is only for illustrative purposes and is not to scale. Measurements of rooms, doors, windows, and any items are approximate and no responsibility is taken for any error, omission or mis-statement. Icons of items such as bathroom suites are representations only and may not look like the real items. Made with Made Snappy 360.

