

**BOLTON ROAD, STRATFORD, LONDON. E15 4JY**



**£1,950 PCM**

**AN EXTREMELY WELL PRESENTED AND SPACIOUS FOUR BEDROOM HOUSE SITUATED IN A TURNING OFF OF HAM PARK ROAD BEING CLOSE TO WEST HAM PARK AND NOT FAR FROM STRATFORD SHOPPING CENTRE AND STATION. WOULD SUIT FOUR PROFESSIONAL SHARERS. EPC RATING C**

- **FITTED KITCHEN/DINER**
- **LOUNGE**
- **GROUND FLOOR WC**
- **FIRST FLOOR BATHROOM/WC**
- **DOUBLE GLAZED**
- **WELL MAINTAINED REAR GARDEN**
- **WOULD SUIT SHARERS**
- **CONVENIENT LOCATION**
- **VIEWING RECOMMENDED**



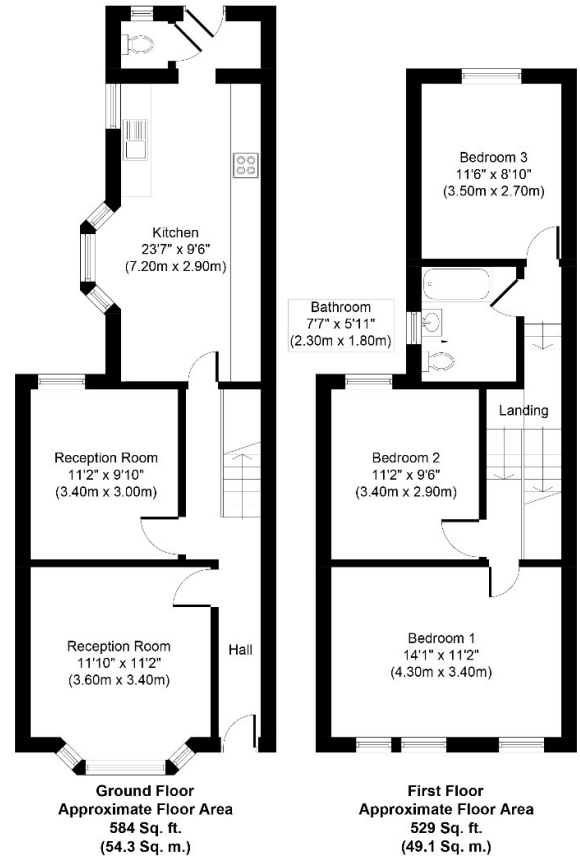

Whilst every attempt has been made to ensure the accuracy of the Floor plan contained here, measurements of doors, windows, rooms and any other items are approximate and no responsibility is taken for any error, omission, or mis-statement. This plan is for illustrative purposes only and should be used as such by any prospective purchaser or tenant. The services, systems and appliances shown have not been tested and no guarantee as to their operability or efficiency can be given.  
 Copyright V360 Ltd 2021 | www.houseviz.com